

Product Manual - Long Span III Wall Panels - Miami Dade

EA37/AB-MD, Outside Closure Installation at Eave
MP04/AB-MD, Approved Allowables and Design Notes
RC63/BB-MD, Panel Marking and Sidelap Details
RC91/BA-MD, Erection Notes
WC05/AB-MD, Fastener Layout
WC06/AB-MD, Wall Panel Endlap (At Girt)
WC61/AB-MD, Basic Parts and Pieces

Outside Closure Installation at Eave
Long Span III Walls
EA37/AB-MD

PRIOR TO FASTENING, INSIDE CLOSURES ARE TO BE SANDWICHED BETWEEN THE STRUCTURAL SUPPORT FRAME AND THE WALL PANEL. OUTSIDE CLOSURES ARE TO BE SANDWICHED BETWEEN THE OUTSIDE CLOSURE FLASHING AND THE WALL PANEL.

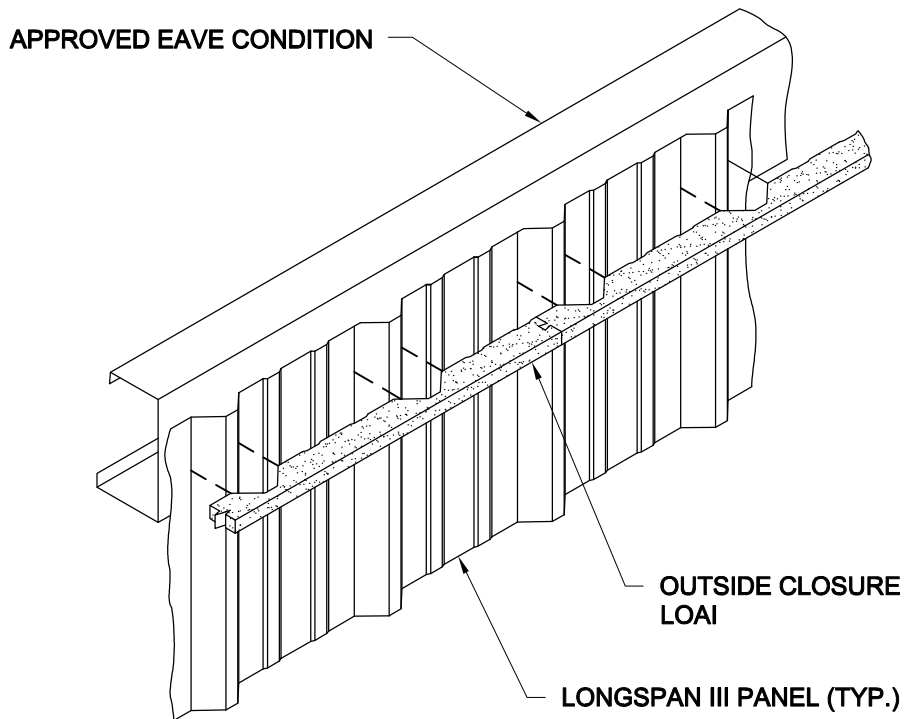

OUTSIDE CLOSURE INSTALLATION AT EAVE
LONG SPAN III WALLS

EA37
AB-MD

[Download the DWG file by clicking here.](#)

[To Section Index](#)

Approved Allowables and Design Notes
Long Span III Walls
MP04/AB-MD

THE MAXIMUM PANEL SPAN AND THE MAXIMUM DESIGN PRESSURE FOR THIS
WALL PANEL SHALL BE BASED ON THE FOLLOWING PANEL ALLOWABLES:

MAXIMUM ALLOWABLE BENDING MOMENT (AT SUPPORTS) = 156.3 ft-lbs.

MAXIMUM ALLOWABLE BENDING MOMENT (BETWEEN SUPPORTS) = 87.5 ft-lbs.

MAXIMUM ALLOWABLE PANEL REACTION (AT SUPPORTS) = 312.5 lbs/ft

PANEL'S EI VALUE (POSITIVE PRESSURE) = 1,972,000 lbs- in²

PANEL'S EI VALUE (NEGATIVE PRESSURE) = 1,321,000 lbs- in²

MAXIMUM ALLOWABLE PANEL DEFLECTION = L/240

NOTE:

THIS WALL PANEL IS APPROVED FOR SPANS OF UP TO 5'-0" MAXIMUM
ATTACHED TO 16 GA. (MIN.) SUPPORTS

APPROVED ALLOWABLES AND DESIGN NOTES

LONG SPAN III WALLS

MP04
AB-MD

[Download the DWG file by clicking here.](#)

[To Section Index](#)

Panel Marking and Sidelap Details
Long Span III
RC63/BB-MD

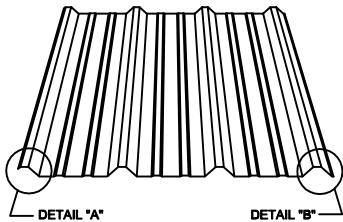

LONG SPAN III PANEL

SAFETY PRECAUTION:
DO NOT STEP ON RIB OF PANEL. ALWAYS STEP ON FLAT SURFACE.

SAFETY PRECAUTION:
DO NOT STEP ON PANELS UNTIL FULLY SECURED WITH FASTENERS.

LONG SPAN III PANEL IDENTIFICATION MARK NUMBER

EXAMPLE: LSP 24 - 30.0
 30'-0" IN LENGTH
 24 GAGE
 LONG SPAN III

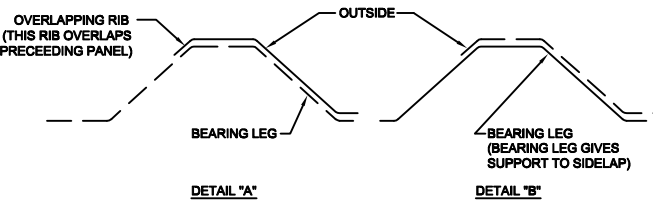

SIDELAP DETAIL

EACH PANEL SHALL BE PERMANENTLY LABELED WITH MANUFACTURER'S NAME, LOGO AND MIAMI-DADE ACCEPTANCE NO. ERECTION OF THE LONG SPAN PANEL REQUIRES THAT THE PROPER DIRECTION OF ITS APPLICATION BE MADE. THE DESIGN OF THE PANEL INCORPORATES A BEARING LEG INTO ITS LEADING EDGE WHICH PROVIDES SUPPORT FOR PROPER NESTING OF THE OVERLAPPING RIB OF THE NEXT PANEL. THE INSTALLATION OF THE PANELS (SHOWN AT LEFT) PROCEEDS FROM LEFT TO RIGHT. HOWEVER, UNLESS FIELD CIRCUMSTANCES DICTATE OTHERWISE, INSTALLATION OF PANELS CAN PROCEED FROM EITHER LEFT TO RIGHT OR RIGHT TO LEFT AS LONG AS THE OVERLAPPING RIB IS LAPPED OVER THE BEARING RIB.

PANEL MARKING AND SIDELAP DETAILS
LONG SPAN III

**RC63
BB-MD**

[Download the DWG file by clicking here.](#)

[To Section Index](#)

Erection Notes
Long Span III
RC91/BA-MD

ERECTION NOTES:

1. ALL AREAS WHERE MASTIC IS TO BE APPLIED SHOULD BE WIPED CLEAN WITH A MILD DETERGENT OR AN ALL PURPOSE CLEANER BEFORE MASTIC APPLICATION. THIS WILL INSURE A GOOD SEALING SURFACE AND IMPROVE WEATHER TIGHTNESS.
2. THE BLANKET INSULATION MANUFACTURER RECOMMENDS THAT DOUBLE SIDED TAPE BE USED TO SECURE THE INSULATION TO THE EAVE. AMERICAN BUILDINGS COMPANY IS NOT RESPONSIBLE FOR THE INSTALLATION OR ATTACHMENT OF THE INSULATION. ADDITIONAL ATTACHMENTS (NOT BY ABC) MAY BE REQUIRED.
3. ALL EXPOSED FASTENERS SHOULD PENETRATE THE SEALANT FOR THE MOST WEATHER TIGHT CONNECTION IN ROOF AND WALL AREAS WHERE APPLICABLE.
4. WHEN FIELD CUTTING PANELS OR TRIM DO NOT USE ABRASIVE SAWS OR OTHER CUTTING METHODS WHICH PRODUCE HOT METAL PARTICLES OR BURN THE CUT EDGES. THESE METHODS WILL DAMAGE THE PAINTED AND GALVALUME FINISH AND VOID ANY WARRANTIES. USE DOUBLE CUT SHEARS, NIBBLERS OR OTHER CUTTING DEVICES WHICH DO NOT PRODUCE HOT METAL PARTICLES OR BURNED EDGES.

ERECTION NOTES

LONG SPAN III

RC91
BA-MD

[Download the DWG file by clicking here.](#)

[To Section Index](#)

Fastener Layout
Long Spann III Walls
WC05/AB-MD

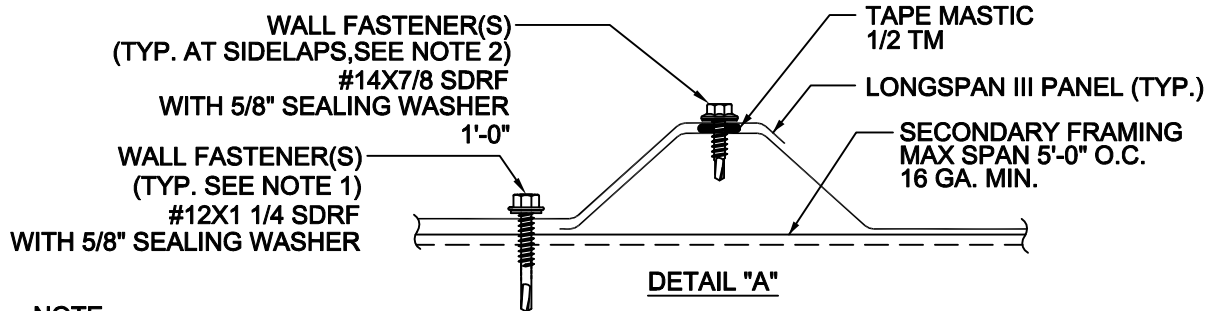

NOTE:

1. WALL FASTENER(S) #12X1 1/4 SDRF WITH 5/8" SEALING WASHERS REQUIRED AT SIDEWALL AND ENDWALL GIRTS, BASE ANGLE, EAVE STRUT AND GABLE ANGLE.
2. WALL FASTENER(S) #14X7/8 SDRF WITH 5/8 SEALING WASHER AS SHOWN REQ'D. ONLY AT PANEL SIDELAPS OR AT FLASHING LAPS AND FLASHING TO PANEL CONNECTIONS.

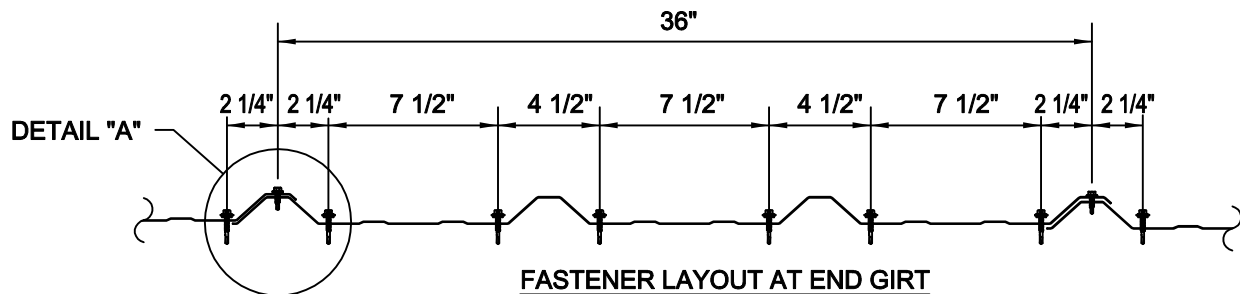
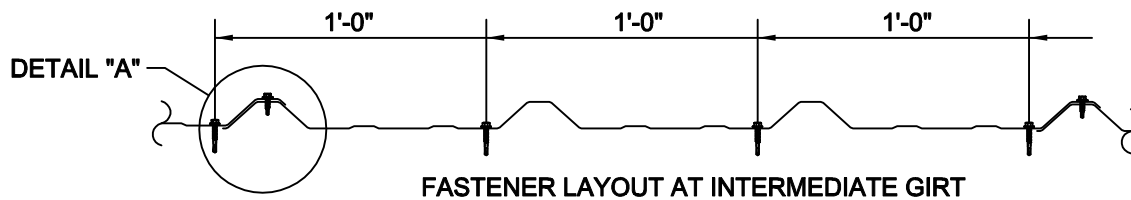

FASTENER LAYOUT

LONG SPAN III WALLS

WC05
AB-MD

[Download the DWG file by clicking here.](#)

[To Section Index](#)

Wall Panel Endlap (At Girt)
Long Span III Walls
WC06/AB-MD

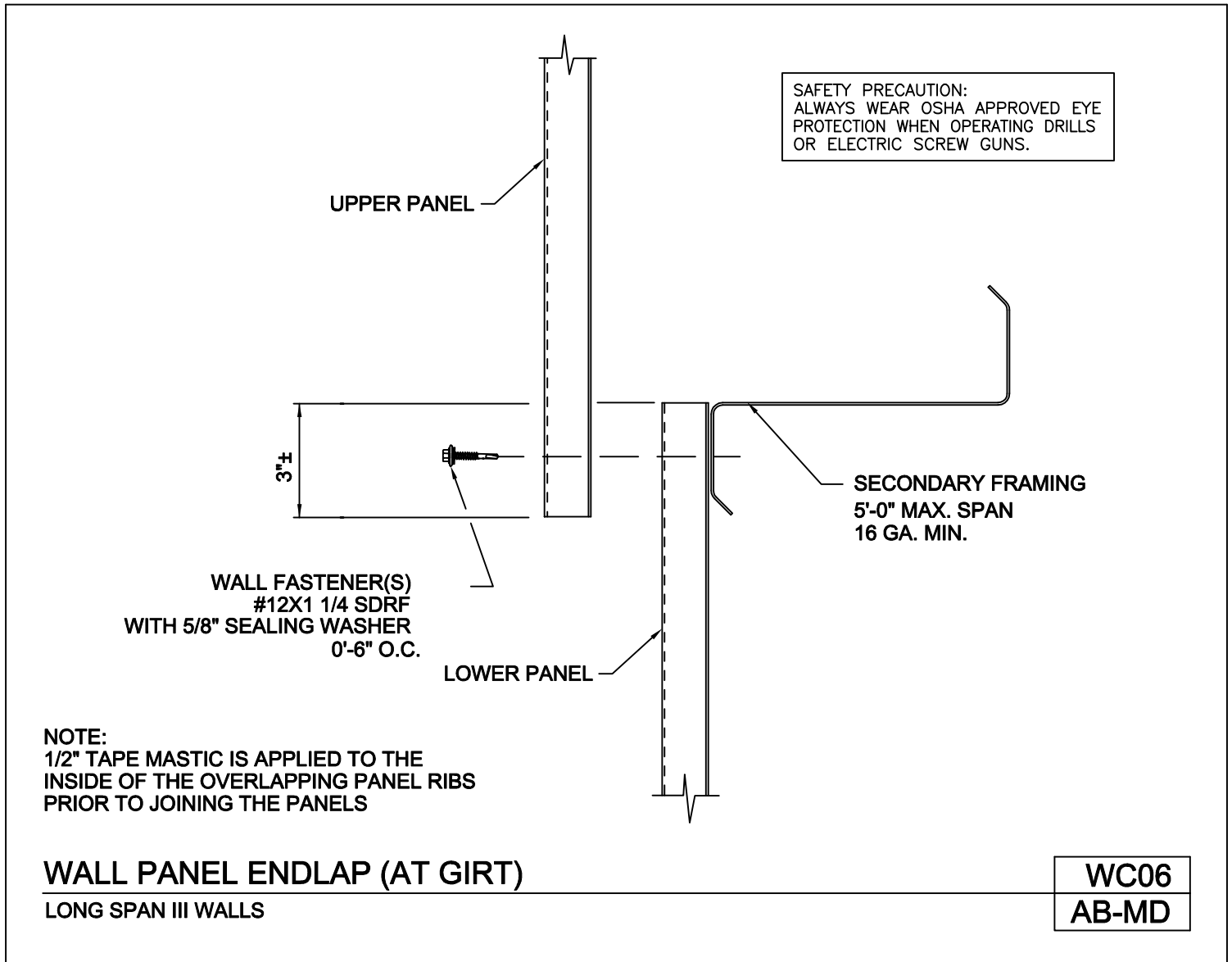

[Download the DWG file by clicking here.](#)

[To Section Index](#)

Basic Parts and Pieces
Long Span III Walls
WC61/AB-MD

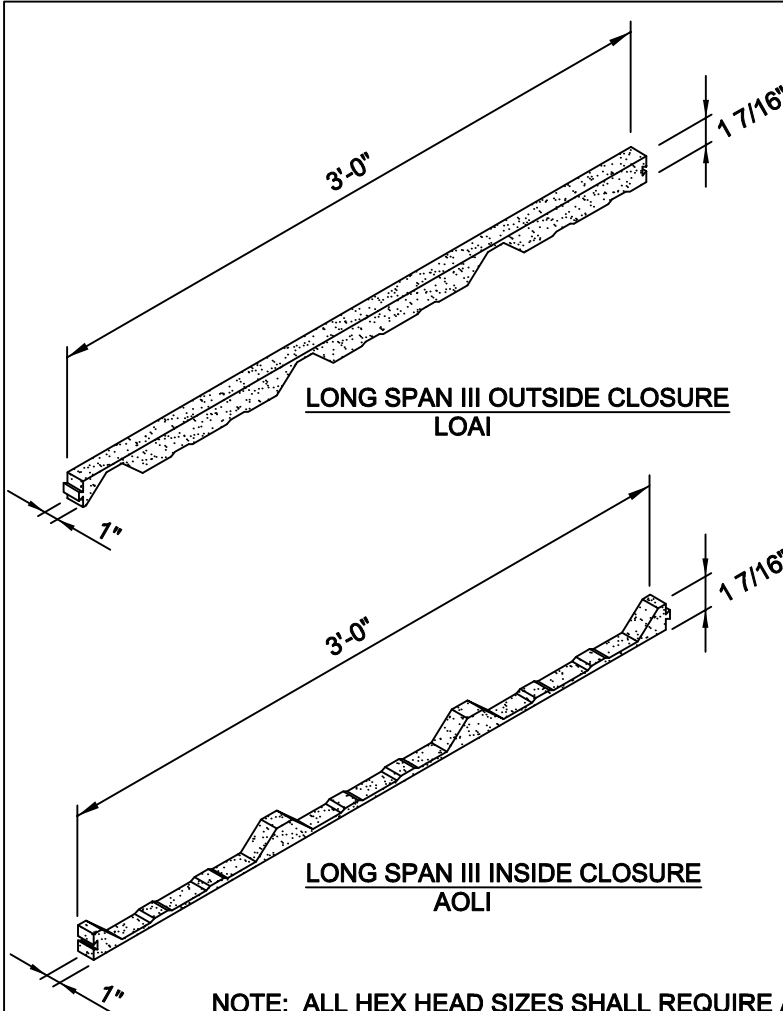

NOTE: ALL HEX HEAD SIZES SHALL REQUIRE A 5/16" HEX SOCKET UNLESS NOTED.

BASIC PARTS AND PIECES

LONG SPAN III WALLS

WALL FASTENERS

DESCRIPTION

#12 X 1 1/4
SELF DRILLING CARBON STEEL HEX HEAD
FASTENER WITHOUT WASHER
MARK NO. #12X1 1/4 SDHH



APPLICATION

CLIPS AT OVERHEAD DOORS,
WALK DOORS, ETC.

DESCRIPTION

#12 X 1 1/4
SELF DRILLING COLOR MATCHING HEX HEAD
FASTENER WITH 5/8" SEALING WASHER
MARK NO. #12X1 1/4 SDRF



APPLICATION

SHEET TO STRUCTURAL CONNECTIONS
(BASE & GABLE ANGLE, GIRTS, EAVE
STRUTS, ETC.)

DESCRIPTION

#14 X 7/8"
SELF DRILLING COLOR MATCHING HEX HEAD
FASTENER WITH 5/8" SEALING WASHER
MARK NO. #14X7/8 SDRF



APPLICATION

PANEL SIDELAP CONNECTIONS, FLASHING TO
PANEL CONNECTIONS AND OTHER SHEET TO
SHEET CONNECTIONS

**WC61
AB-MD**

[Download the DWG file by clicking here.](#)

[To Section Index](#)